



PolyLoc

Information Guide

stormbuildingproducts.com



PolyLoc

Some Things Just Click

NO
GLAZING
BARS

ORDER
TODAY!



An easy-fit roofing panel which provides the ideal DIY roofing solution for verandas, canopies or carports. The easy-fit panels simply click and lock together to provide an instant roof.

- » Lightweight for easy handling
- » Speedy assembly, no specialist tools required
- » Impact-resistant polycarbonate
- » Hardwearing, durable and long-lasting materials
- » Easy installation

Call the STORM team today on 01278 455326 to place your PolyLoc order



PolyLoc

Installation Manual

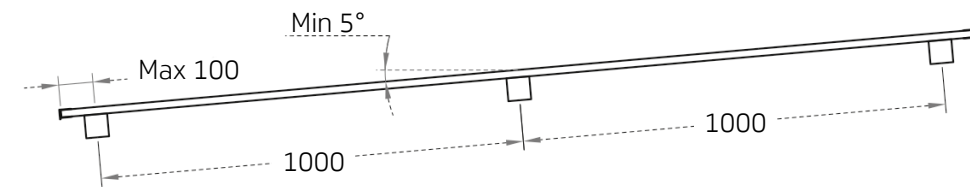
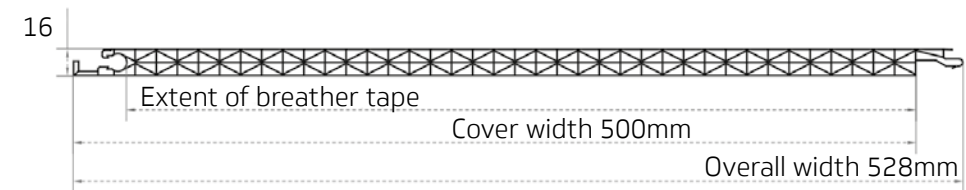

PolyLoc

Installation Components

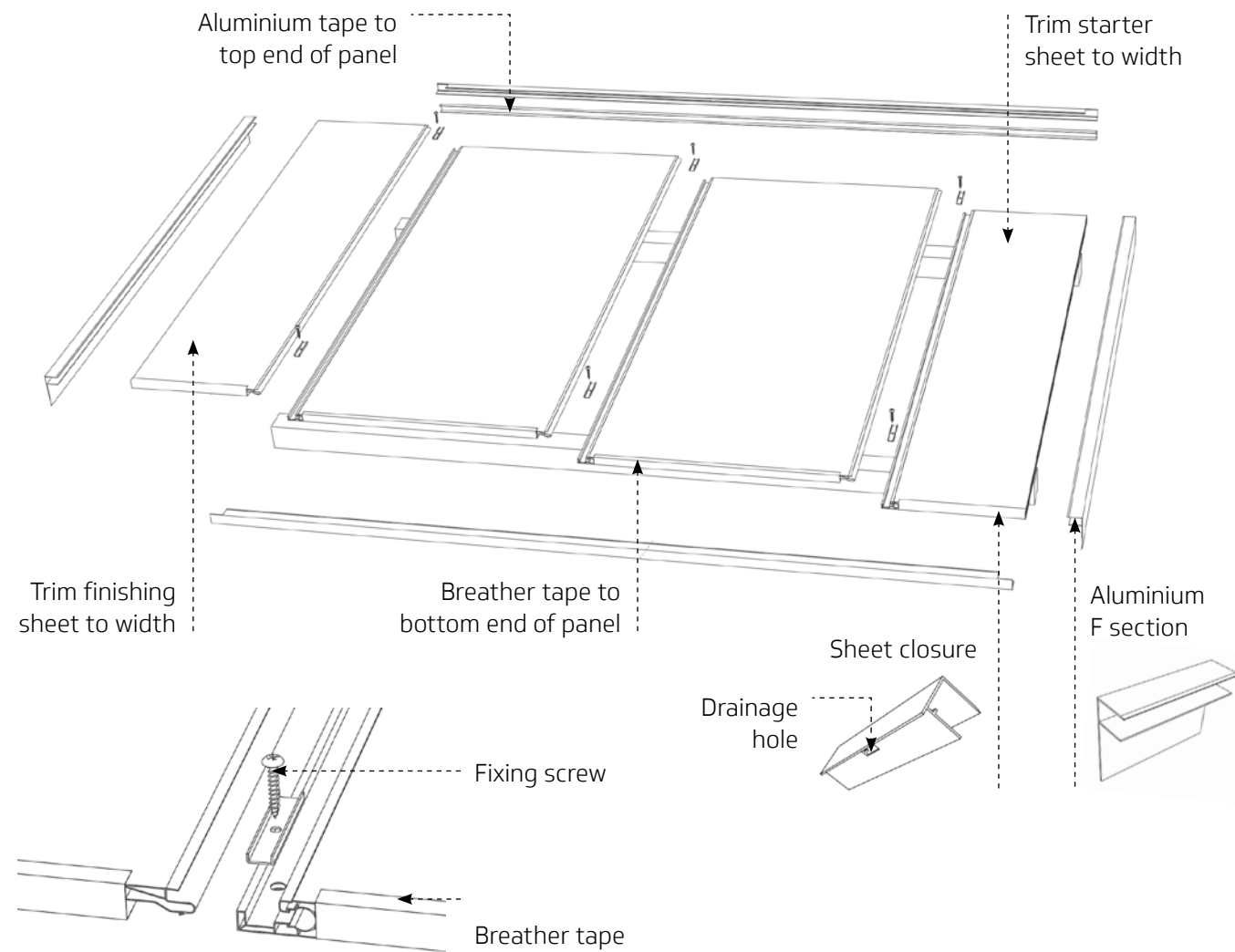



Properties

Thickness	16mm
Cover Width	500mm
U-Value	2.0W/m ² K
UV Protection	As indicated

Light Transmission

Colour	Light	Solar
Clear	66%	69%
Opal	59%	39%

Spanning

Purlin Centres (mm)	Load (N/m ²)
800	1000
1000	450
1200	500

UV Protection

STORM PolyLoc has a coextruded UV protection layer on one side.

Recommendations

Minimum roof slope 5° / Maximum sheet length 4.5m.

Warranty

There is 10 year limited warranty against loss of light transmission, yellowing and weather impact available for this product.

Quality

Manufactured under ISO 9001: 2015

Handling and Safety

Do not step directly on the roof light. Use stepping boards. Work according to local safety regulations.

Storage

Store in a shaded place, protect from direct sunlight and rain prior to installation. Avoid covering the sheets with heat-absorbing materials. Avoid contact with chemicals. Protect the sheets from physical damage.

Installation

- Make adequate allowance for thermal movement, nominally 3.5mm per metre.
- Holes drilled for fixings must be oversized.
- Sheet lengths must be limited to ensure there is no excessive movement at the end laps or fixings.
- Do not overtighten fixings.
- Remove protective film on installation.

Service Temperature

For stable prolonged service ranging from -20°C to 100°C (short term unstressed -40°C to 130°C).

Maintenance

In order to maintain a good condition of this product, it should be cleaned periodically using suitable detergent cleaning agents. Do not use solvent cleaners. Do not scrub with brushes or sharp implements. Avoid cleaning in hot sun or high temperatures.



STORM[®]
BUILDING WITH PLASTIC

PolyLoc

For more information, call **01278 455326**,
email **sales@stormbuildingproducts.com**
or visit **stormbuildingproducts.com**